

EXTRACT FROM OPOTIKI MINUTE BOOK VOLUME 34 FOLIO 131

DATED 6 TH MARCH, 1957.

PRESENT: B. Sheehan - Commissioner
I. Kingi - Clerk & Interpreter

207

from p.129

20/- Ct: Under Sec.4181(a)/1953 a roadway is laid off over Allots 303 & 311 Parish of Waiotahi - no compensation. Route shown on plan attached to application. Under Sec.421/1953 recommendation to issue to Minister of Works that roadway shall be declared a road. This roadway is referred to as Crowley's Road. Width of road variable but minimum 1 chain.

*421 order to be drawn
when roadway surveyed
2. Pishana
29.9.60*

24191

MAORI LAND COURT
ROTORUA
12 FEB 1957
WAIARIKI DISTRICT

IN THE MAORI LAND COURT
WAIARIKI DISTRICT

1106

IN THE MATTER of Sections 415, 420 and 421
of "The Maori Affairs Act ..
1953".

24191

THE CHAIRMAN COUNCILLORS AND INHABITANTS of the COUNTY OF
OPOTIKI do hereby apply for an order : _____

MAORI LAND COURT
WAIARIKI DISTRICT
Recd. 12 FEB 1957
16996
Rotorua

1. LAYING off roadways at least one chain wide over...
Allotments 125, 335, 336, 337, 339, 341 and 342 Parish of
Waiotahi, for the purpose of providing access or improved
access to Maori land, European land and Crown land. _____

2. RECOMMENDING to the Minister of Works that the said
roadway be declared a public road. _____

DATED the 6th. day of February 1957. _____

OPOTIKI COUNTY COUNCIL

by its Solicitors

Handwritten signatures and notes:
34/1/51
20/- [Signature]

SEE SEARCH ATTACHED.

Handwritten: 27/2/57

169960

339
337
336 N-2
342

Handwritten: 1/4/57

OPOTIKI

- 6 MAR 1957 206

TS & HODGSON
ERS, SOLICITORS, & NOTARIES
NELSON MAILE HODGSON
NOTARY PUBLIC
JAMES THOMAS HODGSON

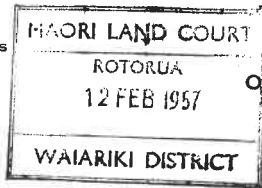

OPOTIKI,
NEW ZEALAND

P.O. BOX 18
TELEPHONE 61

8th February 1957

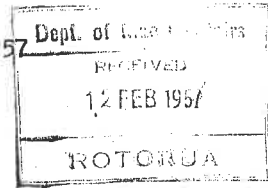

The Registrar,
Waiariki Maori Land Court,
Private Bag,
ROTORUA.

Dear Sir,

re - Opotiki County Council

We send you herewith an Application for an Order laying off roadways over Allotments 125, 335, 336, 337, 339 341 and 342 Parish of Waiohaki, and shall be obliged if this Application can be advertised for the sitting of the Court at Opotiki in March. We enclose fee £1.0.0.

Yours faithfully,

Approved
Miss Millson

NVH:RJT.
(encl)

BLOCK: Parish of Waioatahe Allotment 125

TITLE: Seeds under 10-270.

AREA: 50 acres.

OWNERS: Louisa Aggariz and 13 other owners.

ALIENATIONS - NIL

BLOCK: Parish of Waioatahe Allotment 335

TITLE: Crown Grant under Land Transfer dated 3rd December 1879 - Vol. 18 Folio 166.

AREA: Sacra : 1 rood : 36 perches.

OWNERS: Hinehou Te Reweti and 7 other owners.

ALIENATIONS - NIL - See Bd File 12/6500.

37
T
T
T
T
T
T
T

BLOCK: Parish of Waioatahe Allotment 336 No. 1

TITLE: Partition Order dated 7th March 1946.

AREA: 1 acre : 2 roods : 10 perches

OWNERS: Tamatekapua Te Raiki m.a.
Tuterangianini Hall m.a.

ALIENATIONS: NIL.

BLOCK: Parish of Waioatahe Allotment 336 No. 2

ALIENATIONS: Sold to H. E. Luttrell - See Bd. File 12/6630.

BLOCK: Parish of Waioatahe Allotment 337

TITLE: Certificate of Title - Gisborne Registry 70/110

AREA: Sacra : 0 roods : 25 perches.

OWNERS: Tiskere Te Ani m.
Hinehou Te Ani
Poi Te Ani
Erana Te Ani

ALIENATIONS: NIL. See Bd File 12/6499.

BLOCK: Parish of Waioatahe Allotment 339

TITLE: Crown Grant under Land Transfer dated 3rd December 1879. Vol: 18 Folio 185

AREA: Sacra : 3 roods : 13 perches.

OWNERS: Kerihiri Te Popo f.
Te Nganopo Te Popo f.
Kipa Te Popo m.
Waremu Te Popo m.
Horama Te Popo m.
Ani Te Popo f.

ALIENATIONS: - NIL

BLOCK. Parish of Waioatahe Allotment 341

TITLE Certificate of Title 66-234 Gisborne Registry

AREA 5 acres

OWNERS. Hemi Te Pūnewa
Ua Makerewhata

ALIENATIONS - NIL.

BLOCK : Parish of Waioatahe Allotment 342.

TITLE : Grant under Confiscated Lands Act. 1867
dated 3rd December 1879.

AREA : 5 acres : Oroods : 12 perches.

OWNER: Te Otini - sole owner.

ALIENATIONS - NIL.

SEARCHED BY :- AHTViniata
27/2/57

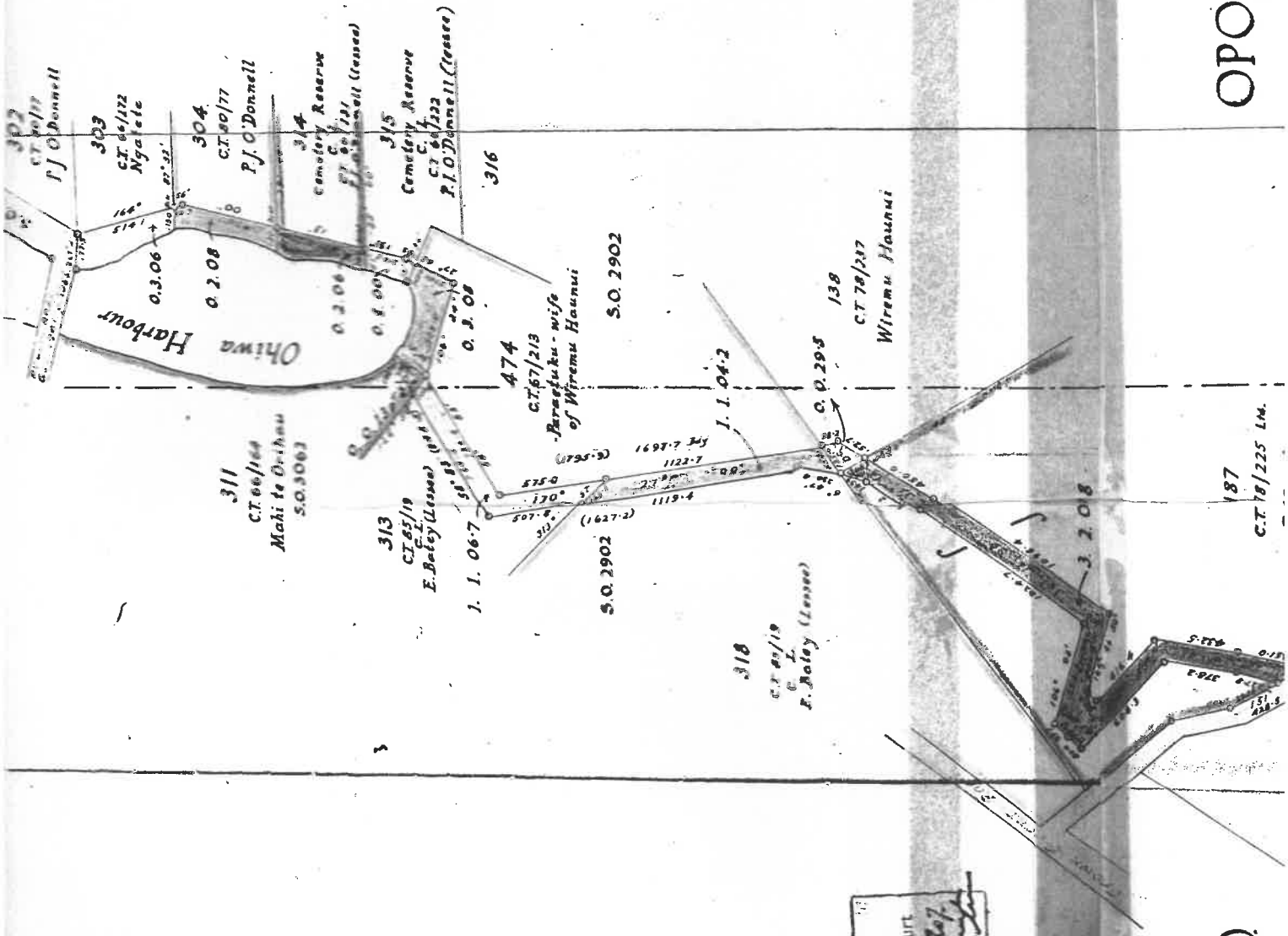

I

VII

Exhibit A
Produced before the Court
Opotiki 11. 3. 1907
Date 6 3 07

OPOTIKI S. D.

TANE S. D.

Wiremu Hounas

Exhibit A
Produced before the Court
14.B. 34 1956
Date 6 3 57
J.P. Hounas

WHAKATANE S. D.

OPOTIKI

APPROVED.

Chief Surveyor
15/1956

Land to be taken for Road
through or adjoining Allots 303, 304, 314, 315, 4
138, 187, 126, 127

Parish of Waitotahi
Comprised in C's T 66/131, 164, 172, 222, 67/213, 78/135, 11
Blocks VII, Whakatane S. D. & Block I
Gisborne Land District. Opotiki
Surveyed by R. C. Davies, November
Scale: Six chains to an inch.

S.O. 4698

Detl. P.V.H., May, 1956

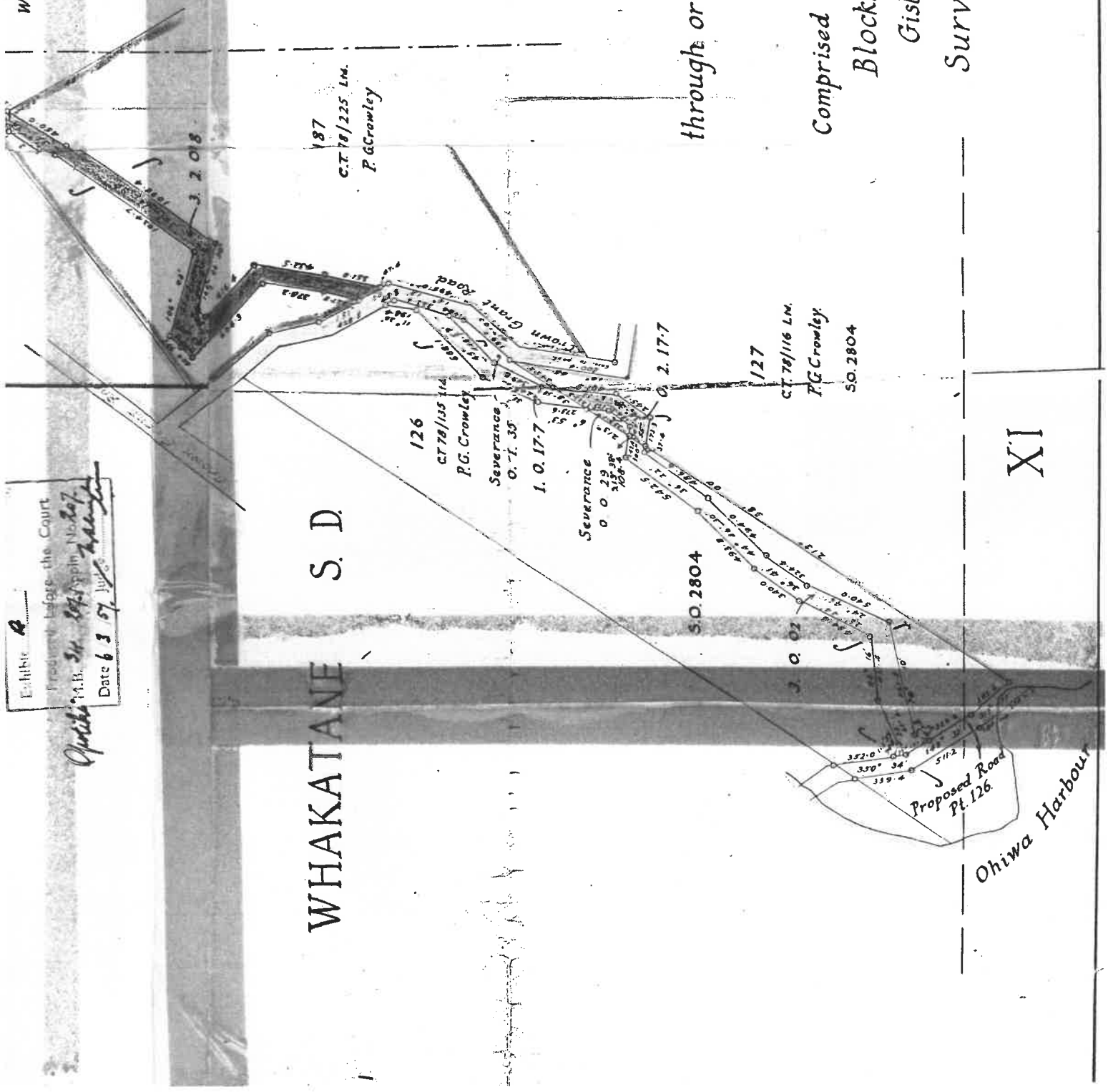

XI